

# Service Road 29 & 30 Rear Property Restoration



## Naturalization/Restoration Planting Zone (T1 - T2)

Plant native tree & shrub species to replace ash tree cuttings and also to provide under-story cover to prevent the opportunities for invasive species from coming in. Recommended species: White Pine, White Spruce, White Oak, Pin Oak, Sugar Maple, Alternative Leaf Dogwood, Freeman's Maple, White Birch, Basswood, Shagbark Hickory, Hybrid Poplar, Eastern Red Bud, Witch Hazel, Common Elderberry, Chokecherry.

## Shrub Nodal Planting Zone (S1 - S5)

Use berry producing native shrub species to provide birds with potential food sources and habitat. Plant low grow species on the area closer to property line and taller species to be planted on woodlot side. Recommended species: Serviceberry, Gray Dogwood, Gro-Low Fragrant Sumac, Snowberry, Black Chokeberry, Flowering Raspberry, Common Ninebark.

## Woodlot infill/Under-story planting (IF)

Add oak and maple species to infill and fast growing species to provide immediate canopy cover to inhibit establishment of invasive species. Recommended species: White Oak, Pin Oak, Sugar Maple, Basswood, Hybrid Poplar, Witch Hazel, Chokecherry, Alternative Leaf Dogwood, Common Elderberry.

## 3m Setback Zone

3m away from property line, keep this area with no plantings

## Wildflower Meadow (WM)

Enhance existing meadow area by adding butterfly attracting native grass & wildflower species. Recommended species: Big Blue Stem, Little Blue Stem, Indian Grass, Switch Grass, Butterfly Milkweed, Wild Bergamot, Purple Coneflower, Black-eyed Susan, New England Aster, Pearly Everlasting, Woodland Sunflower.

## Wet Forest (WF)

Enhance existing wetland by planting wet tolerant species. Recommended species: Tamarack, White Cedar, Yellow Birch, Red Maple, Freeman's Maple, Red Osier Dogwood, Highbush Cranberry, Nannyberry, Buttonbush, Speckled Alder. Bird boxes can be added to enhance habitat.



# Service Road 29 & 30 Rear Property Restoration



## The process of property restoration around Service Road 29 & 30 will include:

- Enhance existing wetland by planting wet tolerant species;
- Removal of existing invasive species to reduce competition;
- Mowing of grass to reduce the presence of non-native species and overgrowth;
- Removal of woody debris dumpings to prevent fires; and
- Planting of native grasses and wildflowers;
- Application of herbicide to remove remaining invasive species;
- Planting of native berry producing shrubbery to provide birds with potential food sources;
- Naturalization planting using native tree & shrub species to replace ash tree cuttings; and
- Provide under-story cover to inhibit the establishment of invasive species
- Install bird boxes to enhance habitat.

## Existing conditions of Service Road rear property



**Behind property of 9373** Existing wet pocket, tree cutting & mowing



**Behind property of 9317** Woody debris dumping



**Behind property of 9285** Woody debris dumping & using as outdoor storage place



# Service Road 29 & 30 Rear Property Restoration

## Existing conditions of Service Road rear property



Behind property of 9261 Mowing



Behind property of 9237 Ash tree logs from EAB damaged tree cutting left on ground



Behind property of 9201 and 9157 Removed ash trees & mowing



Behind property of 9125 & 9157

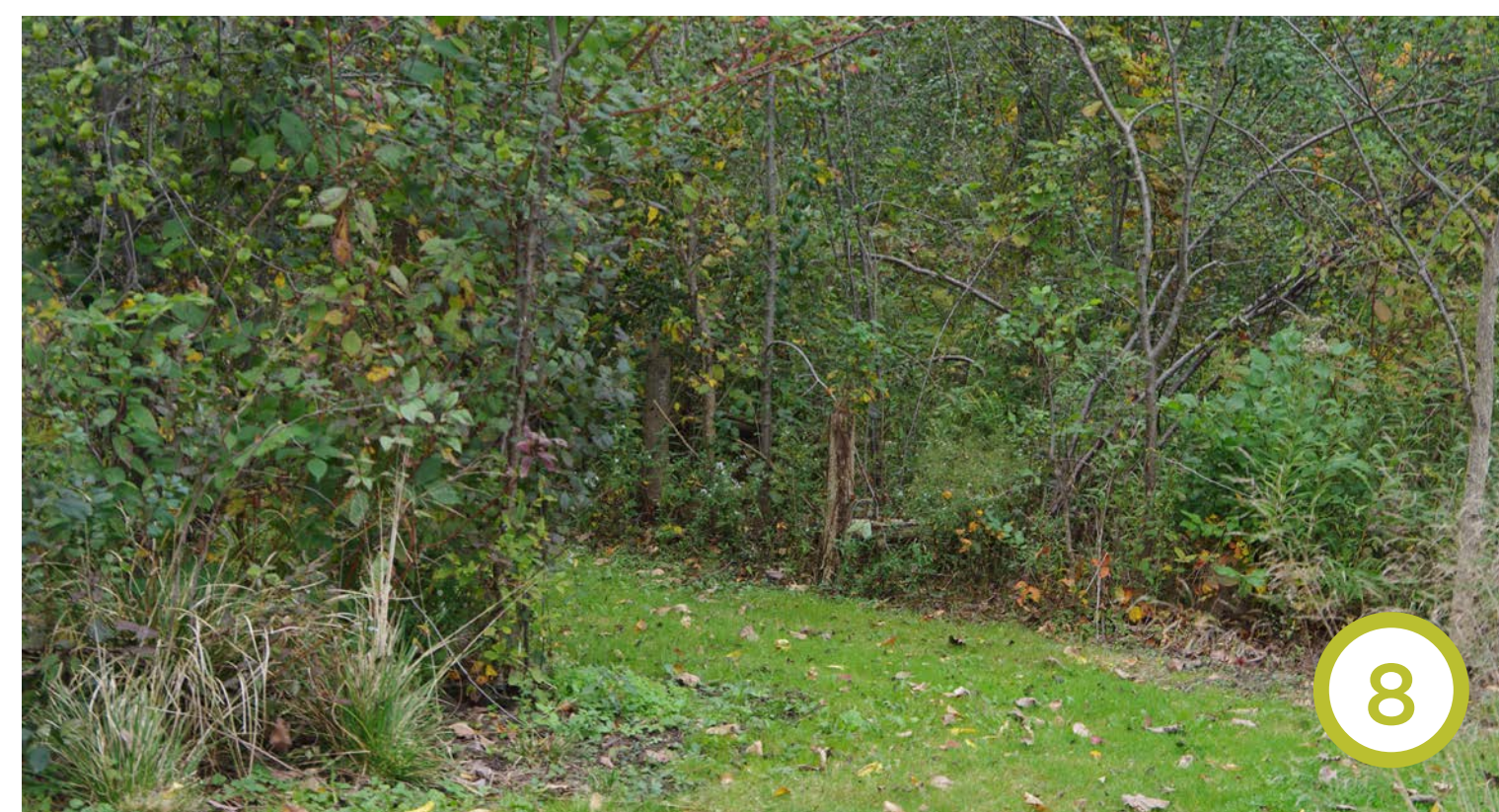

Existing footpath (Mown grass)



Behind property of 9125 & 9091



Behind property of 9091



Behind property of 9063



Behind property of 9033 & 8999



Behind property of 9373 Existing wet pocket, tree cutting & mowing



Site access from 8351 Property



Site access requires ditch crossing



Poison Ivy & Garlic Mustard (Invasive)



Oak Regenerations

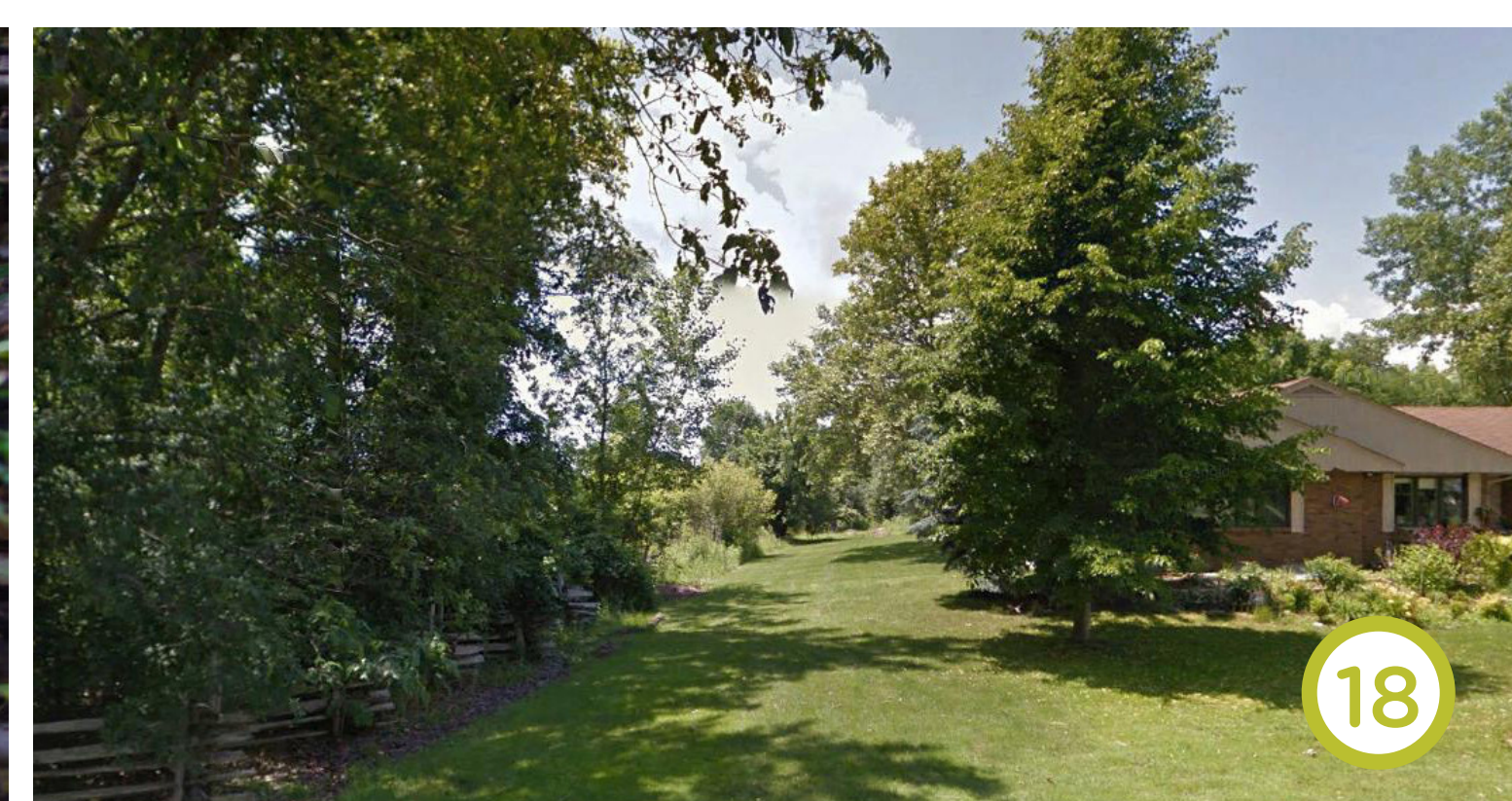

Mown Grass Path



# Service Road 29 & 30 Rear Property Restoration



## Wildflower Meadow

Big Blue Stem, Little Blue Stem, Indian Grass, Butterfly Milkweed, Wild Bergamot, Purple Coneflower, New England Aster, Black-eyed Susan



## Berry Producing Shrub

Serviceberry, Gray Dogwood, Snowberry, Black Chokeberry, Nannyberry, Flowering Raspberry, Speckled Alder, Low grow Fragrant Sumac, Red Osier Dogwood



## Native Tree

White Oak, Pin Oak, Basswood, Sugar Maple, Freeman's Maple, Witch Hazel, White pine, Tamarack, Yellow Birch, Hickory, Eastern Red Bud



10m

5m

0m

Niagara Parks Property Line



Tamarack

Sugar Maple

Snowberry





# Service Road 29 & 30 Rear Property Restoration

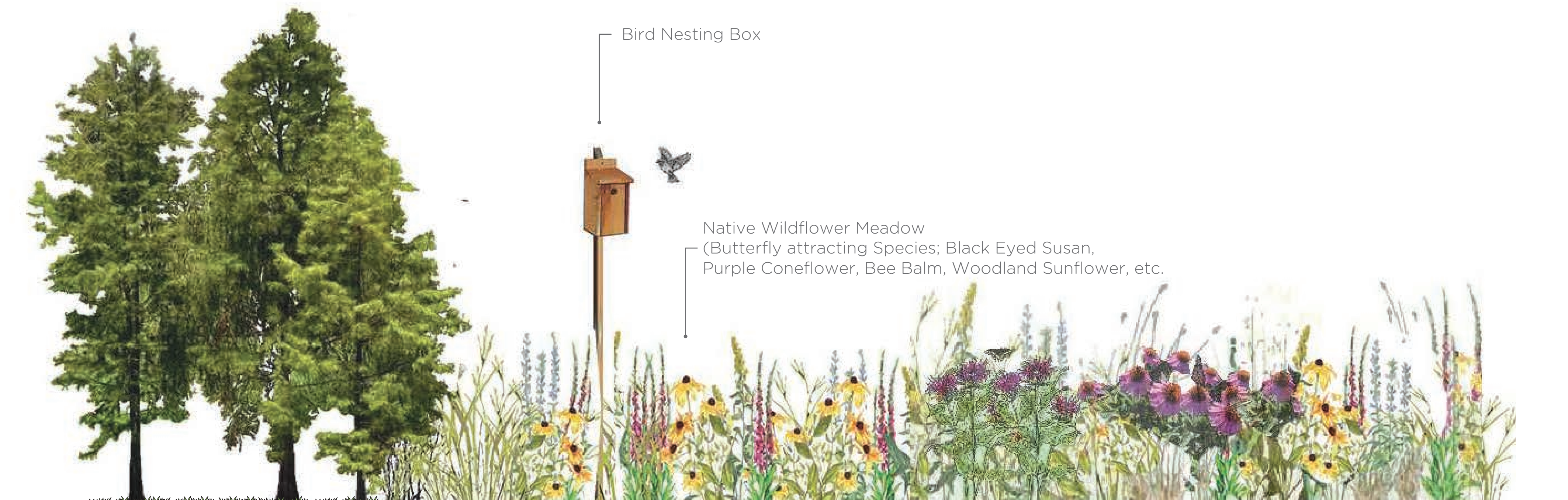



# Service Road 29 & 30 Rear Property Restoration



## Existing Condition vs. Proposed Planting Cross Section

